

Public Use Guidelines

Revised by Point Cabrillo Lightkeepers Association,
December, 2017

Introduction

Previous revisions to the *Point Cabrillo Public Use Guidelines* were developed during a series of community meetings held between October, 2000 and January, 2001. The original guidelines were developed in 1988-89 to provide a basis for ongoing management policy for Point Cabrillo, and served to guide the North Coast Interpretive Association and the Coastal Conservancy from that time until 2002. At that time, ownership of the 300-acre property was transferred to the California Department of Parks and Recreation (PARKS), and a concession contract for management of the 30.5 acre light station was awarded to the non-profit Point Cabrillo Lightkeepers Association (PCLK).

In examining the goals and guidelines for each section of this document, be aware that these revised guidelines differ from the original document in one significant way: for management purposes, the Light Station and the Natural Area are defined as separate and distinct areas within Point Cabrillo Light Station State Historic Park. Some directives apply to only one of the areas, as stated. “Point Cabrillo Light Station State Historic Park,” when used independently of the definitions below, refers to both the Light Station and the Natural Area. The entire property is currently held in public ownership.

The “Light Station” is defined as the 30.5-acre parcel purchased by the U.S. Government in 1908. This parcel includes the Light Station buildings, yards, the bluffs and fields surrounding and to the south of the Station buildings (to the historic fence line), the wetlands surrounding the pond, and Lighthouse Road [see attached map]. The property is designated on the National and State registers of historic sites as the “Point Cabrillo Light Station.”

“The Natural Area” refers to the undeveloped property (approx. 270 acres) surrounding the historic Light Station.

Additionally, the Revised Guidelines contain a section called “Management,” which gives directives for management policy and addresses the role of the community in future planning and stewardship of the Point Cabrillo Light Station State Historic Park (hereafter referred to as PCLSSHP).

Thanks go to the many members of the community who gave their valuable assistance with the original public planning process, and especially for their ongoing interest in and support of the Point Cabrillo Light Station State Historic Park.

Summary of Goals

- 1. In order to preserve its outstanding beauty, historic integrity, and natural habitat values, PCLSSHP shall be pedestrian-oriented.**
- 2. Recreational opportunities shall be provided for the local community and visitors to the Mendocino coast consistent with the preservation of natural, scenic, and historic resources, and without deleterious affects on the surrounding community.**
- 3. Educational programs and exhibits shall be developed to promote understanding of local and natural history and to foster awareness of the effects of humans on the natural environment.**
- 4. The Light Station shall be restored consistent with the Secretary of the Interior's Standards for the rehabilitation of historic structures. The appearance shall reflect the period when the Station was under the management of the U.S. Lighthouse Service.**
- 5. Management activities shall support the continued functioning of the USCG aids-to-navigation.**
- 6. Within the Light Station, historic integrity and public safety shall be the primary considerations in management and maintenance decisions, balanced with natural resource protection and a concern for potential environmental impacts.**
- 7. Within the Natural Area, the preservation of flora, fauna, and wildlife habitat shall be the primary considerations in management and maintenance decisions, balanced with concerns for public safety and public access.**
- 8. Planning for any use shall emphasize enjoyment of the site, maintaining the open space and serenity.**
- 9. Protection of sensitive species and habitats shall be given high priority wherever they occur within the boundaries of the property.**
- 10. Visitor service facilities will be provided to enable enjoyment and use by the local community and visitors to the Mendocino Coast, while maintaining natural, scenic, and historic resources and without any negative impacts on the surrounding community.**
- 11. Activities and any new structures in PCLSSHP shall be designed so as to minimize impact on natural, scenic, and historic resources.**
- 12. Management of PCLSSHP shall adhere to the goals and guidelines of these Revised Public Use Guidelines.**
- 13. Community involvement in management decisions shall be maintained through an independent non-profit that has primary responsibility for stewardship of the Light Station, and will assure that the local community will remain involved in the design, operation, and long-term management of the site.**

I. Public Access

Goals:

In order to preserve its outstanding beauty, historic integrity, and natural habitat values, PCLSSH shall be pedestrian-oriented.

Recreational opportunities shall be provided for the local community and visitors to the Mendocino coast consistent with the preservation of natural, scenic, and historic resources, and without deleterious effects on the surrounding community.

Guidelines:

1. Emphasis shall be placed upon low-impact recreational activities that bring the public closer to nature.
2. A trail system shall be structured to allow a variety of experiences, but designed to minimize visual and physical impacts on habitat and natural, scenic, and historic resources.
3. The trail system and visitation shall be developed and improved consistent with public access policies as outlined in the 1998 Point Cabrillo Public Access Plan.
4. Where necessary, improvements shall be made to the trail system to minimize impacts, direct access, and address public safety. Visitors shall be directed to remain on the trails.
5. Vehicular traffic within PCLSSH shall be minimized. The main access into the site shall be by foot. Bicycles may use Lighthouse Road, but shall not be allowed on trails. All equestrian use shall be prohibited.
6. The primary route for public access to PCLSSH shall be via the entrance at Point Cabrillo Drive. Pedestrian access points from neighboring properties shall not be improved nor shall the public be directed to these access points.
7. There shall be access opportunities for persons with limited mobility, including, where feasible, on improved trails. These shall be located and constructed so as to preserve natural, scenic, and historic resources.
8. For public safety and protection of the resources, access shall be clearly directed, but constructed barriers shall be avoided.
9. Unobtrusive seating is desirable in some locations including along Lighthouse Road and in the vicinity of the Light Station.
10. Access to the north cove beach shall be retained, with improvements where necessary to avoid erosion.
11. PCLSSH shall close to the public at sundown. Access to the Light Station after dark may be considered for special events or supervised activities.

II. Education

Goal:

Educational programs and exhibits shall be developed to promote understanding of local and natural history and to foster awareness of the effects of humans on the natural environment.

Guidelines:

1. The existing interactive educational program and exhibits shall be continued and developed to meet the growing needs of the visiting public and shall reflect the unique history and resources of the Light Station and surrounding area.
2. The education program shall use low-impact, non-consumptive methods to minimize impacts on the Light Station, Natural Area, and marine resources.
3. Education programs and exhibits shall continue to focus on maritime history, the marine environment, historical restoration, and the natural and cultural history of PCLSSHP, Pine Grove, and the Mendocino area. Programs shall provide opportunities for exploring environmental ethics and examining human impacts on plants, wildlife, habitat, and historical resources.
4. The ongoing process of historical research and restoration shall be documented and disseminated to the public. Opportunities for integrating historical research and restoration skills shall be explored as part of educational programming at PCLSSHP.
5. Educational programs for school groups shall be designed to integrate with the curricula and needs of local and visiting schools and colleges.
6. Management shall support the recruitment and training of volunteer docents to address the needs of visiting school groups and the general public.
7. Environmental education professionals shall be hired as staff or under contract to facilitate quality educational experiences for school groups.

III. The Light Station

Goals:

The Light Station shall be restored consistent with the Secretary of the Interior's Standards for the rehabilitation of historic structures. The appearance should reflect the period when the Station was under the management of the U.S. Lighthouse Service.

Management activities shall support the continued functioning of the USCG aids-to-navigation.

Within the Light Station, historic integrity and public safety shall be the primary considerations in management and maintenance decisions, balanced with natural resource protection and the concern for potential environmental impacts.

Definitions:

“Light Station,” used herein, refers to the 30.5-acre parcel purchased by the U.S. Lightkeeping Service in 1908 and currently designated on the State and National Historic Registers. This parcel includes the Light Station buildings and yards, the bluffs and fields surrounding and to the south of the Station buildings (to the historic fence line), the wetlands surrounding the pond, and Lighthouse Road [see attached map].

Guidelines:

1. The historic integrity of the Light Station shall be retained and preserved.
2. The non-profit organization shall have the ability to operate the Fresnel lens as a private aid-to-navigation should it ever cease to be a Federal aid-to-navigation.
3. Signing shall be limited and designed to minimize visual contrast with the historic structures.
4. Parking within the Light Station shall be minimized. Parking areas, which may be necessary to conform to special needs requirements, shall be located to avoid sensitive resource areas and minimize the loss of scenic values.
5. Any new uses that are considered within the Station structures shall be designed in keeping with the pedestrian orientation and historical character of the site.
6. Any new buildings in the Light Station shall be limited to reconstruction of historic buildings in place during the period when the U.S. Lighthouse Service operated the Light Station; these include the barn, pump house, and water tower.
7. The Light Station shall be available for public access and education consistent with goals for protecting the natural, scenic, and historic resources.

IV. Natural Resources

Goal:

Within the Natural Area, the preservation of flora, fauna, and wildlife habitat shall be the primary considerations in management and maintenance decisions, balanced with concerns for public safety and public access.

Planning for any use shall emphasize enjoyment of the site as a natural area, while maintaining the open space and serenity.

Protection of sensitive species and habitat should be given high priority wherever they occur within the boundaries of the property.

Guidelines:

1. Access shall not be directed into wetlands, the inter-tidal zone, and other sensitive habitats. Interpretive information will be provided to increase public understanding of these resources.
2. The trail system shall be improved, as necessary, to minimize impacts on soils and plants and control public access. Low, rustic boardwalks will be utilized where practical, especially where trails will cross riparian drainages.
3. To avoid conflicts with nocturnally active wildlife, Natural Area trails shall close at sundown.
4. Dogs shall be leashed and under control, and remain on trails at all times to minimize conflicts with wildlife.
5. A program of landscape control and restoration shall be designed and supported. The program shall provide for replanting of eroded or denuded sites, preservation of historic or landmark plantings, and control of invasive exotic plants. Mature stands of exotic, woody species shall be preserved for their habitat value, but their seedlings shall be controlled, and a program of gradual replacement with native species shall be implemented.
6. To enhance the natural scenic setting of PCLSSHS, and when financially feasible, the existing electric utility lines along Lighthouse Road should be relocated underground.
7. Interpretive signage shall be designed and placed for minimal impact on the natural, scenic, and historic resources.
8. No hunting, harvesting, or collecting of animals, plant life, or artifacts by the visiting public shall be allowed.

V. Visitor Service Facilities

Goal:

Visitor service facilities will be provided to enable enjoyment and use by the local community and visitors to the Mendocino Coast, while maintaining natural, scenic, and historic resources and without any negative impacts on the surrounding community.

Guidelines:

1. Improvements shall be designed and located to minimize the need for construction of roadways. Access shall be on a walk-in basis as far as possible.
2. Automobile parking areas shall be limited in size by the visitor carrying capacity of PCLSSHP, as determined by flora and fauna baseline studies.
3. Public camping shall not be permitted within PCLSSHP.
4. The principal vehicular parking site for visitors shall continue to be located in the vicinity of Point Cabrillo Drive and Lighthouse Road, near the main entry control point. It shall be of a size adequate to prevent parking overflow onto Point Cabrillo Drive.
5. New facilities shall be designed to minimize impact on the surrounding community, consistent with preservation of natural, scenic, and historic resources.
6. All visitor service facilities shall be ADA-accessible.
7. The farmhouse near the entry gate shall be used primarily for interpretation purposes.

VI. Control of Environmental Impacts

Goal:

Activities and any new structures in PCLSSHP shall be designed so as to minimize impact on natural, scenic, and historic resources.

Guidelines:

1. Use of pesticides and herbicides shall be avoided in the Natural Area except under rare circumstances in which a critical need demands extraordinary measures. Alternative means of control shall first be thoroughly researched and tested. Chemical components and application methods shall be selected for the least possible impact on neighboring species.
2. Conflicts with surrounding residential areas shall be minimized through use of landscape screening, wooden fencing, signing, and trail alignments, but new obstructions to existing private views into PCLSSHP shall be avoided.
3. All automobile use areas shall be designed to reduce erosion potential and to contribute to groundwater recharge. Permeable surfacing materials shall be used wherever feasible.
4. To minimize impacts on the bluffs and inter-tidal zones and to protect the Marine Protected Area, recreational diving shall only be permitted from the beach in Frolic Cove.
5. Management decisions and all scheduling of activities shall take into account the safety of resident, migratory, nesting, and sensitive species.
6. To protect native species, feral cats and dogs shall be controlled by live trapping and relocated to appropriate facilities.
7. A fire protection system for PCLSSHP shall be maintained.
8. The archaeological resources of PCLSSHP shall be protected and the historic activities of Native Americans and Pine Grove settlers shall be examined and documented.

VII. Management

Goal:

Management of PCLSSHP shall adhere to the goals and guidelines of these Revised Public Use Guidelines.

Community involvement in management decisions shall be maintained through an independent non-profit that has primary responsibility for stewardship of the Light Station, and will assure that the local community will remain involved in the design, operation, and long-term management of the site.

Guidelines:

1. PCLSSHP shall remain held in trust for the public.
2. To support the stewardship of the Light Station, a non-profit shall retain and determine the use of the buildings, consistent with these Revised Public Use Guidelines.
3. The non-profit may generate income from the site and outside sources. Income generated by the non-profit shall be retained and used by the non-profit for the benefit of PCLSSHP.
4. Any revisions to or departure from these Revised Public Use Guidelines will be determined with public input. Major use, policy, or budgetary, changes proposed for the site by PARKS shall be reviewed with the non-profit and the community prior to implementation
5. Management shall support meaningful volunteer participation in programs, administration, and operations. Volunteers shall have influence in the design and management of programs on an ongoing basis.

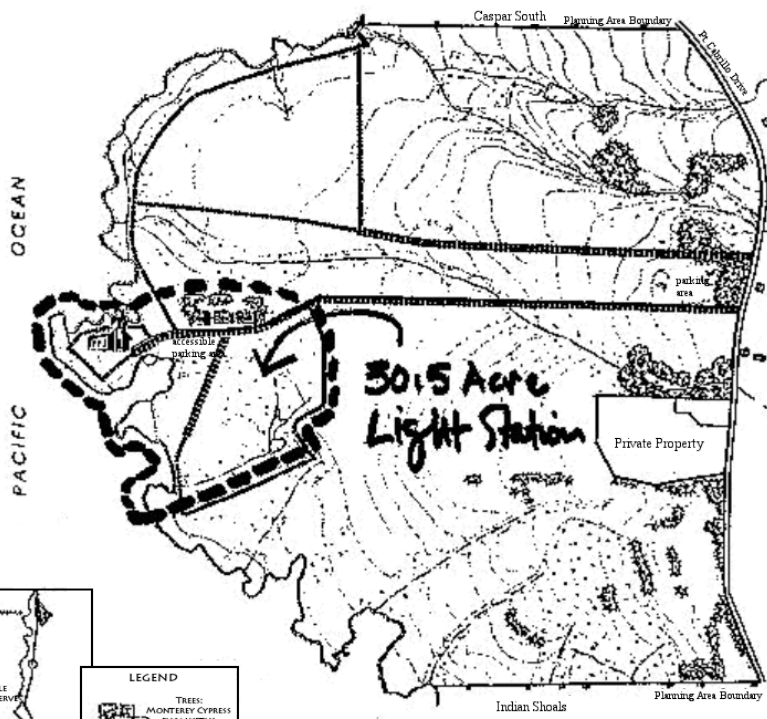

PUBLIC ACCESS TRAILS		
SYMBOL	IMPROVEMENT	DESCRIPTION
	SEMI-PAVED AND PAVED TRAILS	SIGNED AND MAINTAINED FOR PUBLIC USE
	UNPAVED TRAILS	SIGNED AND MAINTAINED FOR PUBLIC USE
	PARKING AREA	PAVED PARKING AREA FOR 3 & CARS
	ACCESSIBLE PARKING AREA	PAVED PARKING AREA FOR 5 CARS

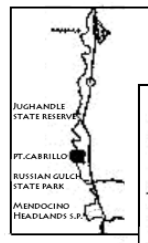

LEGEND	
	TREES: MONTEREY CYPRESS
	EUCALYPTUS
	WETLAND & RIPARIAN AREA
	STREAM
	POND
	ROCKY TERRACE
	BEACH
	BUILDINGS

POINT CABRILLO LIGHT STATION
AND STATE HISTORIC PARK
 MENDOCINO, CALIFORNIA JANUARY, 1988
 TEXT SHARPENED DECEMBER 2017
PUBLIC ACCESS TRAILS
 A project of
 The Coastal Conservancy &
 The North Coast Interpretive Association